

CO20002 Ty'r Winch Road (Footway Improvements)

Consultation Report

October 2022

Introduction

Public consultation was undertaken on a proposal to improve the walking and cycling infrastructure in the area of Ty'r Winch Road in the Pontprennau & Old St Mellons Ward. The public consultation was undertaken between 05/08/2022 and 26/08/2022.

Consultation Activities

The following activities were undertaken to promote consultation:

- Letter drop to properties in the vicinity of the scheme
- Site notices in the vicinity of the scheme
- Email to stakeholders and statutory consultees
- Information on Council Website

Consultation Results

2 individual responses were received during this public consultation, a breakdown of this response is as follows:

2: have provided comments / suggestions but do not state whether they support or object to the proposal

Consultation Outcome

In view of the public consultation it is proposed to **proceed** with the amended proposal as shown on the attached plan.

Specific Issues

Specific issues raised through the consultation are set out below with the Council's response, where the same issue has been raised by a different responder these have been grouped together.

Issue	Response
Comments were received stating that the introduction of the priority narrowing directly opposite the junction of The Ton will prevent vehicles being able to turn right during peak times due to queuing traffic.	As part of the initial development of this scheme travel flow surveys were undertaken along Tyr Winch Road and also around the junction of The Ton. The Traffic flow movements around the junction of The Ton during peak hours were extremely low. However, after discussions with the design team the location of the proposed priority narrowing give way road marking has now been relocated further north away from the junction of The Ton (<i>see Site Notice 2</i>).
Comments were received regarding if The Ton could be resurfaced as part of these works.	The funding for this Scheme has been awarded from the Welsh Government Active Travel Fund (Active Travel to Schools), and there are no additional funds available towards resurfacing side roads as part of this scheme.
Concerns were raised that the proposed junction modifications around The Ton will make it more dangerous for drivers.	<p>Whilst there will be a reduction in road width around this junction, sufficient road width will remain for two way traffic flow through this junction. There will be occasions where large vehicles (such as refuse vehicles) will have to overlap both lanes, however there are many instances around the City where this is normal practice for larger vehicles manoeuvring around junctions. Due to the road width being narrowed this will mean that drivers will have to reduce their speed when approaching the junction.</p> <p>"Track-runs" have been undertaken during the design stage that identify vehicles can undertake turning manoeuvres without being obstructed by the proposed junction layout.</p>
Concerns were raised regarding the visibility of pedestrians using the proposed uncontrolled crossing point at the junction of The Ton.	The positioning of the tactile paving four metres back from the junction is in line with current design standards. Due to the road width being narrowed and also the junction radius being reduced this will ensure drivers will have to reduce their speed when manoeuvring around this junction.
A comment was received stating that the junction modifications around the junction of Tyr Winch Road / Newport Road would reduce the two lanes down to a single lane which could cause congestion along Tyr Winch Road.	We can confirm that for vehicles travelling southbound along Tyr Winch Road towards the junction of Newport Road that there will be sufficient width for two vehicles to wait side by side at this location.

Yn dilyn yr ymgynghoriad diweddar ar newidiadau arfaethedig i'r briffordd, mae'r Cyngor yn paratoui i weithredu'r cynllun rheoli traffig yn seiliedig ar y cynllun diwygiedig a welir. Mae rhagor o fanylion am yr ymgynghori hwn ar gael yn [www.caerdydd.gov.uk/ Projectautrafnidiaeth](http://www.caerdydd.gov.uk/Projectautrafnidiaeth) ar y ddolen 'gweld ymgynghoriadau'.

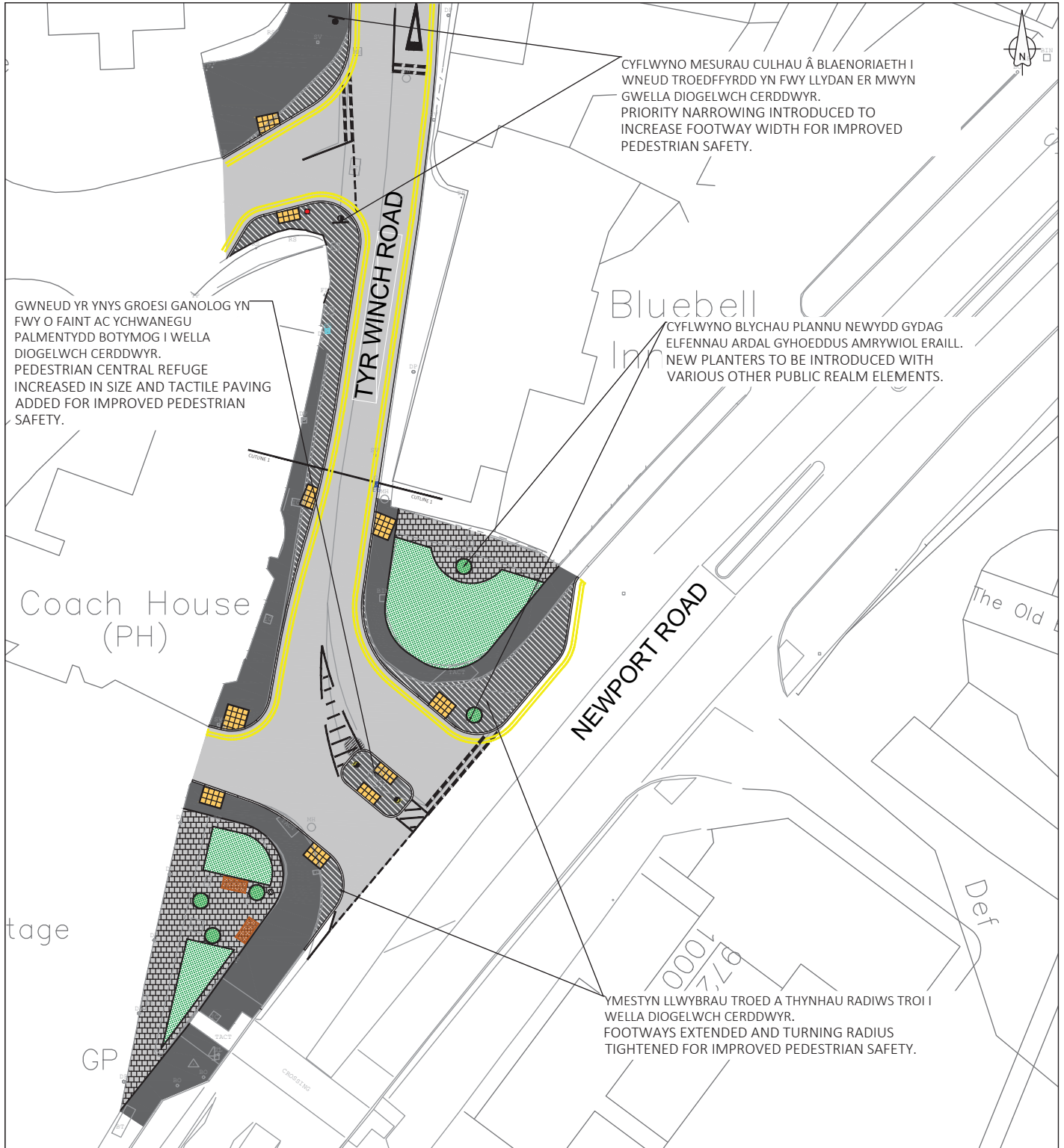

Following the recent consultation on proposed changes to the highway, the Council is preparing to implement the scheme based on the revised plan shown. Further details about this consultation are available at cardiff.gov.uk/TransportProjects using the 'view consultations' link.

